

R2E-100

FOCUSED ACTIVE INFRARED REQUEST-TO-EXIT SENSOR



PRIMARY APPLICATIONS



Focuses On Door Handle



Ignores Cross-Traffic



Virtual Push Plates

DESCRIPTION

BEA's UL Listed R2E-100 is a request-to-exit sensor with an active infrared (AIR) detection zone focused directly on the door handle. This allows the R2E-100 to only detect people intending to exit through the door as they reach for the door handle.

The AIR based R2E-100 improves accuracy of detection as compared to passive infrared (PIR) technology including ground based errors, PIR sensor spoofing, known PIR vulnerabilities (hot air, background objects, cross traffic).

FEATURES & BENEFITS

- UL 294 / ULC S319 Listed
- Adjustable tilt angle from 0° – 10°
- Adjustable detection range from 20 – 48 inches*
- Low profile sensor mounts on or above the door frame
- Multiple re-locking modes for timed or door position conditions
- Relay output consists of two Form "C" contacts for NO / NC wiring
- Three DRY auxiliary inputs: request to exit, card reader and push button

*The R2E-100 can accommodate swinging doors up to 7 feet



BEA, Inc.
RIDC Park West
100 Enterprise Drive
Pittsburgh, PA 15275-1213

Customer Service: 800.523.2462
Technical Support: 800.407.4545
www.BEAinc.com

APPLICATIONS

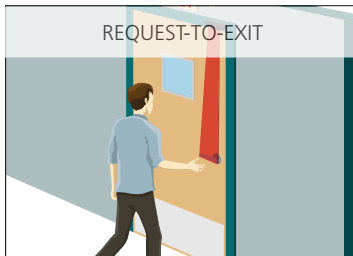

TECHNICAL SPECIFICATIONS

Detector Type	Focused Active Infrared
Supply Voltage	12 – 24 VAC / VDC; $\pm 10\%$ @ 60 Hz
Current	
Sounder OFF	155 mA
Sounder MAX VOLUME	200 mA
Temperature (UL Install)	32 °F – 120 °F (0 °C – 49 °C)
Temperature	-20 °F – 120 °F (-29 °C – 49 °C)
Humidity (ULC S319 Installation)	0% – 93% non-condensing
Humidity (UL 294 Installation)	0% – 85% non-condensing
Detection Range	20 in – 48 in, adjustable
Relay	2 Form "C" contact sets; 1.3 A @ 24 VAC / 30 VDC
Relay Hold Time	0.5 s – 60 s, adjustable
Sounder	85 dB max, adjustable volume
Indicator LEDs	Green, Red, Yellow, Orange
REX Input	DRY contact, NO
Card Reader Input	DRY contact, NC
Door Position Switch Input	DRY contact, NO
Dimensions	6.875 in (W) \times 1.875 in (H) \times 2 in (D)
Material	Plastic (ABS and PC)
Wiring Interface	JST (14-pin) with 4 ft cable
Norm Conformance	UL 294 / ULC S319 FCC Part 15 B

DIMENSIONAL DRAWINGS

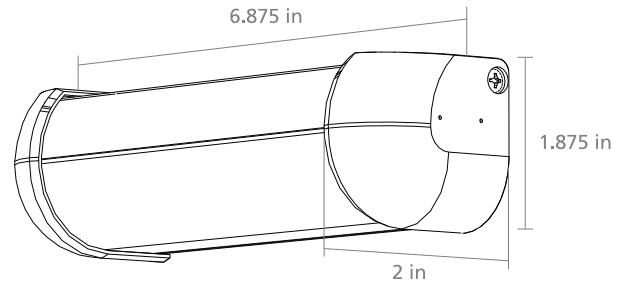

RELATED PRODUCTS



10R2E-100
FOCUSED ACTIVE
INFRARED SENSOR

